



MOPS, INC

# DRAGONFLY TECH ADVANCE PACKET

---

## CONTACT INFO:

Alex Moscatelli (781) 771-2775 [pm1LA@MICAHOTANO.COM](mailto:pm1LA@MICAHOTANO.COM) – PRODUCTION MANAGER

Micah Otano – System Design

**\*Notes:** Please direct all production related questions to the production manager listed above.

## AUDIO SPECIFICATIONS:

### MAIN PA:

- (6) L-Acoustics Arcs W1F0 (x3 per side)
- (2) L-Acoustics SB28 (Dual 18" Sub Cabinets)

### MONITORS:

- (5) QSC K12.2
- (2) L-Acoustics SB28 (Dual 18" Sub Cabinets)

### BAR / BOOTH / STAGE FILLS:

- (6) QSC AD-S282 (Dual 8" two way speakers)
- (2) L-Acoustics SB28 (Dual 18" Sub Cabinets)

### AMPS:

- (2) L-Acoustics LA4X (Arcs W1F0's)
- (2) L-Acoustics LA8 (SB28's)
- (1) QSC CXD4.5 (FILLS)

### PROCESSING:

- (1) QSC Core 110F



# AUDIO CONTINUED.

---

## FOH CONSOLE:

- (1) Behringer X32 - 32 Inputs
- (1) Behringer S32 (Stagebox) - I/O 32in x 16out

## WIRELESS:

- (2) Shure ULX4 Single Channel Receivers - G50
- (2) Shure ULXD2/SM58 Transmitters - Handheld

## MICROPHONES / DI'S:

- (4) Shure SM58
- (6) Shure SM57
- (1) Shure Beta 52A
- (1) Shure Beta 91A
- (3) Sennheiser E604
- (4) Radial PRODI Passive - Mono
- (1) Radial PR048 Active - Mono
- (2) Radial PROD2 Passive - Stereo

## STANDS / CABLES:

- (4) K&M Tripod Tall Boom Stand
- (5) DRPRO Short Boom Stand
- (3) Atlas Sound Straight Stand - Round Base
- (40) 25' XLR Cables
- (6) 20' 1/4" Cables
- (1) Whirlwind 12ch Subsnake
- (2) Whirlwind 25' 8ch XLR Fanout Subsnake

## POWER CABLES:

- (4) 10', 6-Outlet Power Strips
- (6) 25' Triplex Power Extensions (3in - 1out)

## BACKLINE SPECIFICATIONS

### DJ EQUIPMENT:

- (2) Pioneer CDJ2000 Nexus 2
- (2) Technics SL-1200MK7
- (1) Pioneer DJ900 Nexus 2 Mixer
- (1) Denon DJ DS1 Serato Box
- (1) Crane Pro DJ Laptop Stand



# VISUAL DOCUMENTATION

## OVERVIEW (SPEAKER & LIGHTING PLOT)

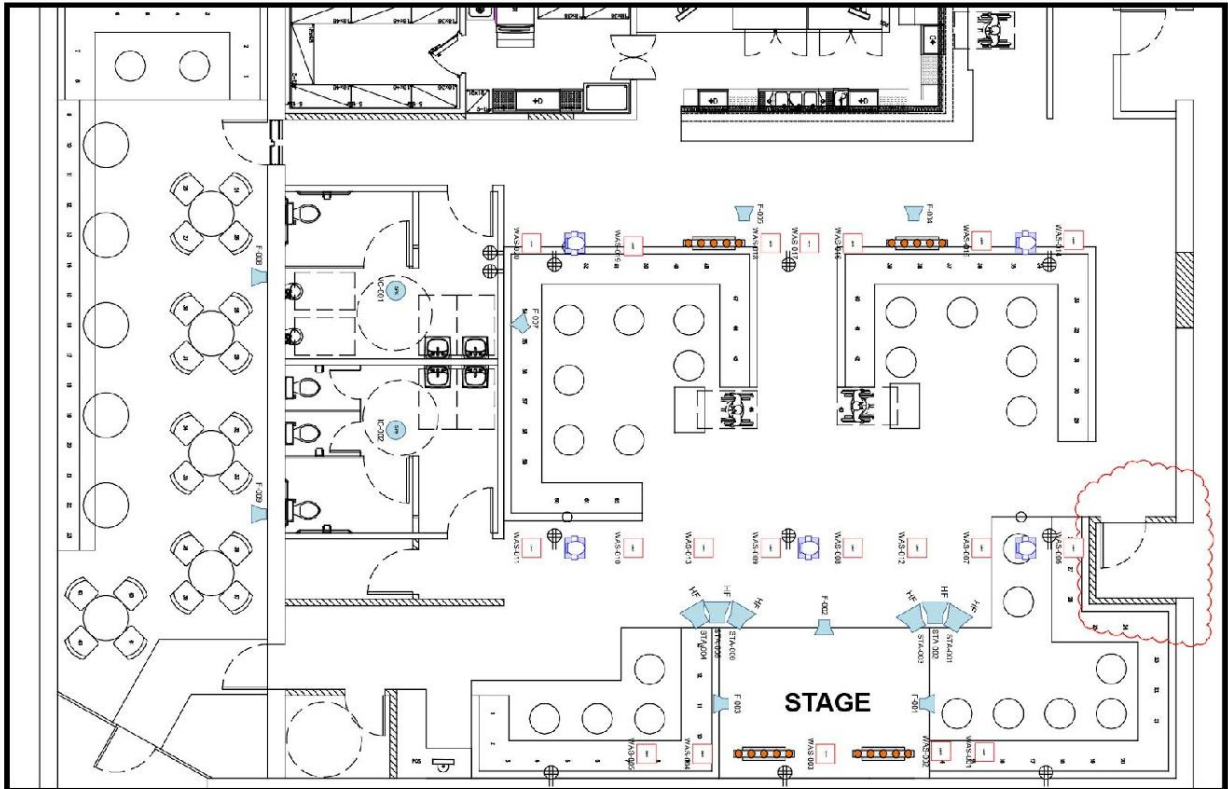



# VISUAL DOCUMENTATION

## AUDIO LINE DIAGRAM

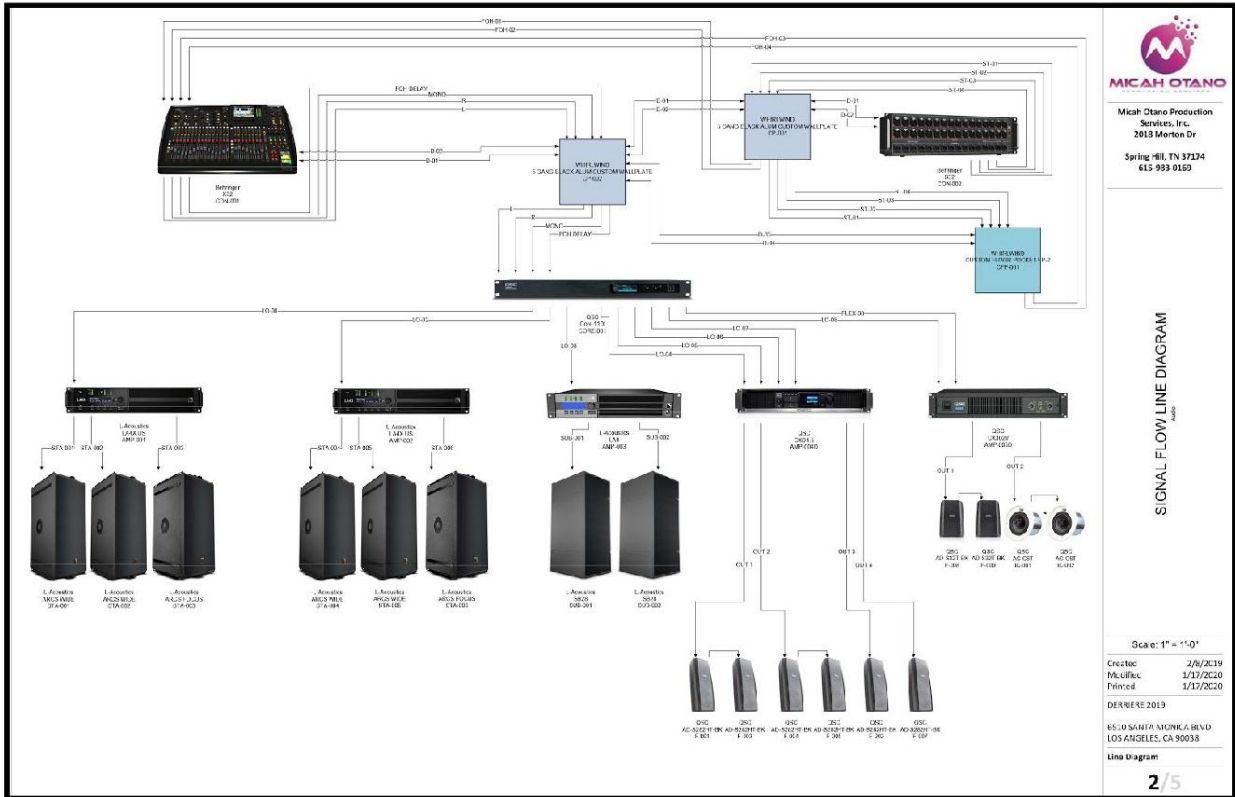

**MICAH OTANO**  
 PRODUCTION SERVICES, INC.  
 Micah Otano Production Services, Inc.  
 2013 Monroe Dr  
 Spring Hill, TN 37174  
 615-993-0169

SIGNAL FLOW LINE DIAGRAM



# VISUAL DOCUMENTATION

---

**PHOTO 1 (DJ BOOTH ONSTAGE)**



*Dragonfly*



MOPS, INC

# DRAGONFLY TECH ADVANCE PACKET

---

## LIGHTING SPECIFICATIONS:

### FIXTURES:

(5) Chauvet Intimidator Hybrid 140SR

(4) Chauvet Rogue R1 FX-B

(20) ADJ Mega 64 Profile Plus

### CONTROL:

(1) grandMA3 OnPC 2 Port Node 2K

(2) Akai APC40 MKII (Midi Controllers)

(1) Cybernet iOne H6 20" All-In-One Touchscreen Computer

(1) Elation Opto Branch 4 DMX Distributor

### ATMOSPHERE:

(1) Reel EFX DF-50 Hazer